

# WasteMaid®

## FOOD WASTE DISPOSERS Elite

# 1980

### MASTER EDITION



3/4 HP



BIO SHIELD (Antimicrobial) for **ODOR PROTECTION!** Disposers are treated with an antimicrobial agent molded inside providing protection against odor causing bacteria growth.



THE TORQUE MASTER GRINDING SYSTEM is a combination of computer designed and balanced components working in unison to provide superior torque grind speed and long system life.

#### Built In Air Switch

The WASTEMAID ELITE 1980 features a Built-In Switch. Turn on your disposer by the power switch or by pushing a button that creates air pressure to turn on disposer. Great option for use with islands.

#### Easy and Fast to Install

WASTEMAID ELITE disposers feature Speed Master Mounting, an exclusive system that provides fast and economical installation.

#### Corrosion Proof

The WASTEMAID ELITE 1980 carries a lifetime warranty against failure due to corrosion.

#### Permanent Magnet Motors

WASTEMAID ELITE motors offer maximum torque instantly with the power to cut through potential jams.

#### Compact and Lightweight

The compact design of your WASTEMAID ELITE allows inclusion where limited under counter space is available.

#### Removable Splash Guard

All WASTEMAID ELITE models have a removable splash guard, ideal for easy cleaning and replacement.

#### SPECIFICATIONS

#### MODEL #1980

<b>HORSEPOWER</b>	3/4 HP
<b>MOTOR SPEED RPM</b>	2700 RPM
<b>VOLTAGE</b>	220-240v
<b>WATTAGE</b>	550
<b>AMPS</b>	3.25
<b>CYCLES</b>	50/60
<b>MOTOR TYPE</b>	Permanent Magnet
<b>SPLASH GUARD</b>	EPDM Rubber
<b>DRAIN OUTLET</b>	Polycarbonate 940
<b>GRIND RING</b>	Stainless Steel
<b>SWIVEL IMPELLERS</b>	Cast Stainless Steel
<b>BALANCED TURNTABLE</b>	Stainless Steel
<b>BALANCED ARMATURE SHAFT</b>	Stainless Steel
<b>HOPPER</b>	ABS
<b>DRAIN HOUSING</b>	Thermoset Polymer
<b>APPLIANCE PROTECTOR</b>	Manual Reset
<b>SINK FLANGE</b>	Polyamide 66
<b>STOPPER</b>	SUS304/NBR/ABS
<b>BEARINGS</b>	Permanently Lubricated, Sleeve Type
<b>SOUND SHELL</b>	Full
<b>SINK WASTE</b>	90 MM
<b>UNIT WEIGHT</b>	6.35 KG
<b>MEASUREMENT A</b>	404 MM
<b>MEASUREMENT B</b>	185 MM
<b>MEASUREMENT C</b>	220 MM
<b>MEASUREMENT D</b>	140 MM
<b>MEASUREMENT E</b>	70 MM
<b>LIFETIME CORROSION GUARANTEE</b>	Yes

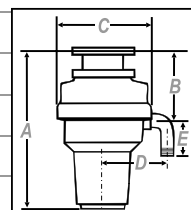

wastemaidshop.co.uk

All Waste Maid Elite Disposers are compliant with the EC Directive regards RoHS.

SS-1980-UK-131